

STATE	FEDERAL AID	STATE	SHEET NO.
ROUTE	PROJECT	ROUTE	PROJECT
VA.	NHPP-064-3(190)	64	0064-121-418, B645
Federal Structure No. 00000000020324		FHWA Construction and Scour Code: X281-SN	
Federal Stewardship and Oversight Code: N/A		UPC No. 119824	

DESIGN EXCEPTION(S):
 Design exception for vertical clearance 14'-3/2"

GENERAL NOTES:
 The original approved sheet, including original signatures, is filed in the VDOT Central Office. Any misuse of electronic files, including scanned signatures is illegal. Violators will be prosecuted to the full extent of the applicable laws.

Width: EBL 63'-11 1/2" face-to-face of curb.
 WBL 53'-11 1/2" face-to-face of curb.

Span layout: 4-span 47'-8 1/8" - 68'-0 3/4" - 68'-1 3/8" - 48'-4 1/2"

Capacity: HS20-44 loading and alternate military loading.

Specifications:
 Construction: Virginia Department of Transportation Road and Bridge Specifications, 2020.
 Design: AASSTO LRFD Bridge Design Specifications, 8th Edition, 2017; and VDOT Modifications.
 Standards: Virginia Department of Transportation Road and Bridge Standards, 2016; including all current revisions.

These plans are incomplete unless accompanied by the Supplemental Specifications and Special Provisions included in the contract documents.

This project is to be constructed in accordance with the Virginia Department of Transportation Work Area Protection Manual, June 2011 and latest revisions.

Deformed reinforcing bars shall conform to ASTM A615, Grade 60. All reinforcing bar dimensions on the detailed drawings are to centers of bars except where otherwise noted and are subject to fabrication and construction tolerances.

Bridge No. of existing bridge is 2812. Plan No. is 171-10, 171-10A and 171-10B.

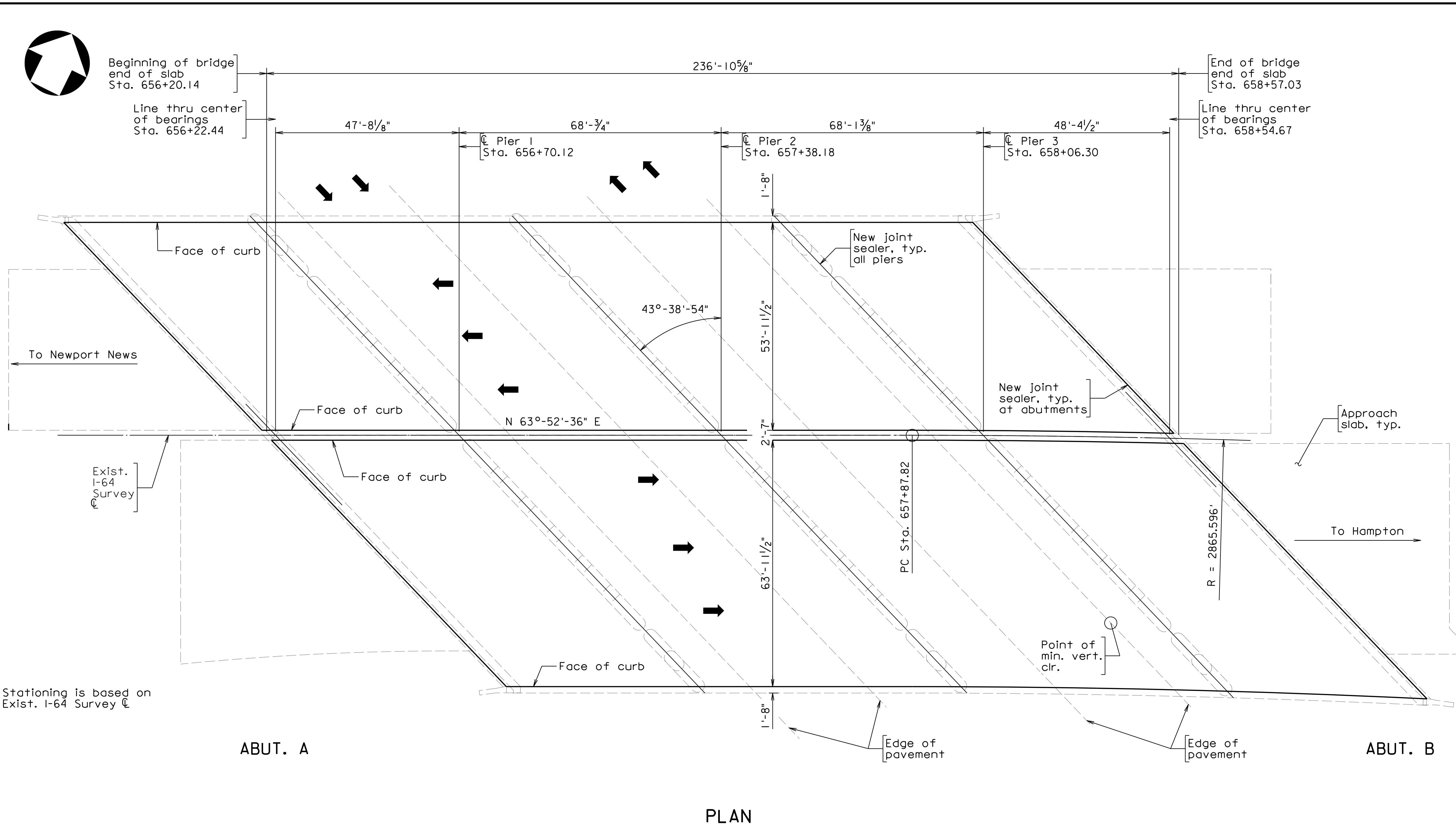

Stationing is based on Exist. I-64 Survey

164 over N. Armistead Ave Gen Plan & Elev

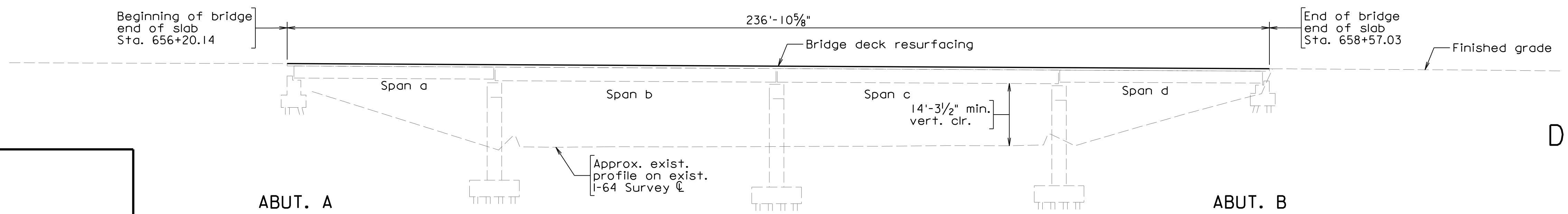

HDR Inc. Virginia Beach, VA. STRUCTURAL ENGINEER	
PLANS BY:	Consultant
COORDINATED:	XXXXX XXXXX
SUPERVISED:	XXXXX XXXXX
DESIGNED:	XXXXX XXXXX
DRAWN:	XXXXX XXXXX
CHECKED:	XXXXX XXXXX

DEVELOPED SECTION ALONG EXISTING I-64 SURVEY

PRELIMINARY PLANS
 THESE PLANS NOT TO BE USED FOR CONSTRUCTION

No.	Description	Date
REVISIONS		
For Table of Revisions, see Sheet 2.		

VDOT
 COMMONWEALTH OF VIRGINIA
 DEPARTMENT OF TRANSPORTATION

PROPOSED BRIDGE REPAIRS ON
 I-64 EB & WB OVER N. ARMISTEAD AVE.
 CITY OF HAMPTON 0.1 MI. E. OF ROUTE 167
 PROJECT NO. 0064-121-418, B645

Recommended for Approval: _____ Developer _____ Date _____
 Approved: _____ Chief Engineer _____ Date _____

STATE	FEDERAL AID		STATE		SHEET
ROUTE	PROJECT		ROUTE	PROJECT	NO.
VA.	-----		64	0064-XXX-XXX, BXXX	2

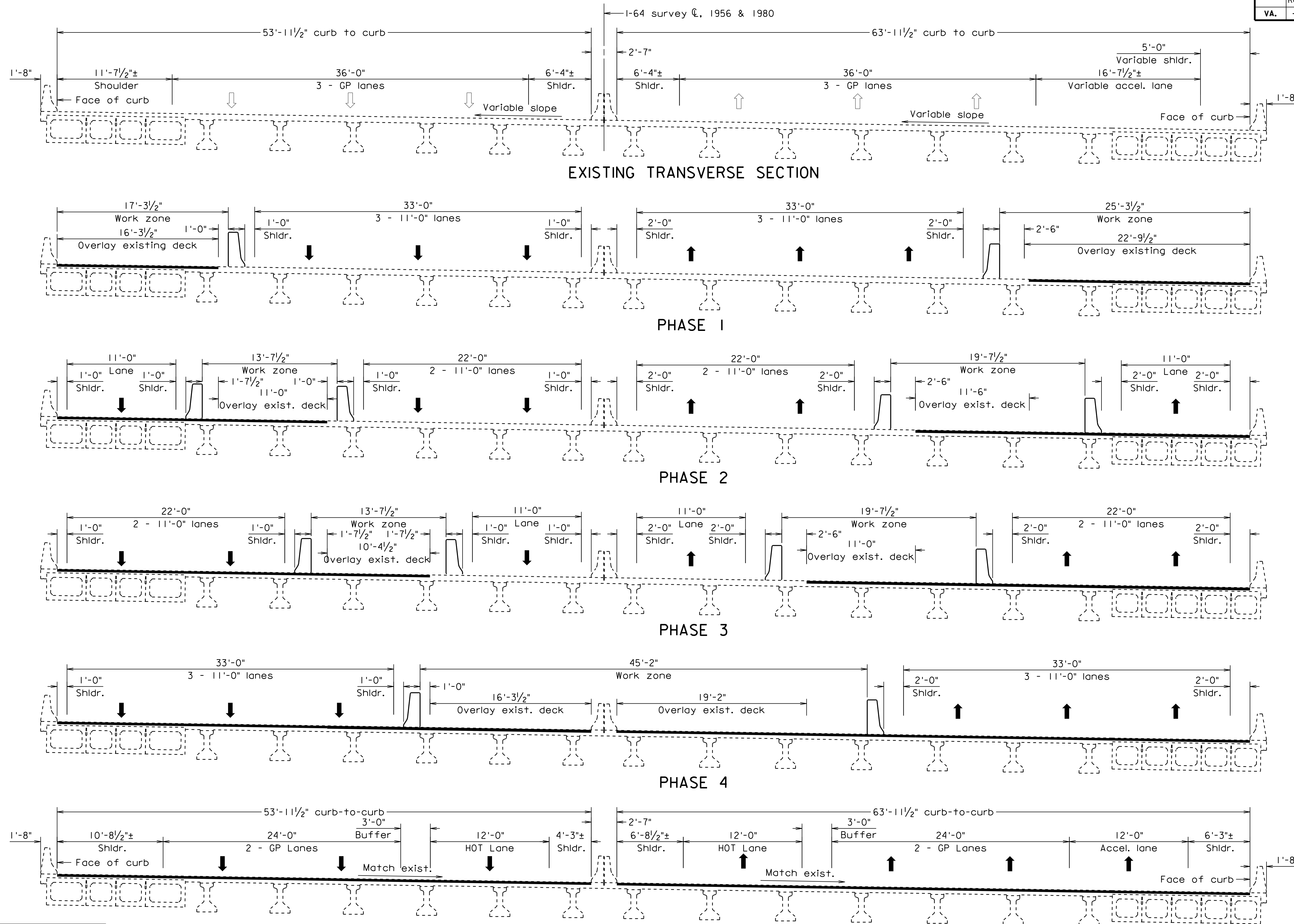

- Notes:
1. All sections shown looking up station (to the east)
 2. Milled (or hydro-demolished) existing deck concrete shall be completely removed from the bridge deck before any repair is performed or overlay work is performed. After milling, limits of deck repair shall be determined and designated using sounding.
 3. The existing concrete surface shall be prepared in accordance with VDOT Road and Bridge Specifications Section 412.03 and the special provisions for latex modified concrete overlay.

I-64 over N Armistead Ave Sequence of Deck Repair

I-64 WB

I-64 EB

FINAL TRANSVERSE SECTION

PRELIMINARY PLANS
THESE PLANS NOT TO BE USED
FOR CONSTRUCTION OF BRIDGE

HDR Engineering Inc.
Virginia Beach, VA
STRUCTURAL ENGINEER

Scale: 3/16" = 1'-0"

© 2021, Commonwealth of Virginia

COMMONWEALTH OF VIRGINIA DEPARTMENT OF TRANSPORTATION STRUCTURE AND BRIDGE DIVISION					
SEQUENCE OF DECK REPAIR					
No.	Description	Date	Designed: MSM	Date	Plan No.
			Drawn: JMF	Aug. 2021	171-10C
			Checked: JMF		2 of 2
Revisions					